

LED Down Light Panel - User Guide.

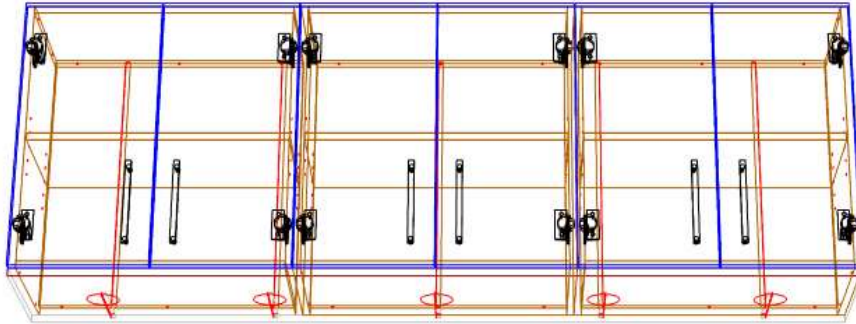

Introduction

Overview

- The 'LED Down Light Panel Package' from Solid Setup Plus adds the Light Panel under Upper cabinets to Cabinet Vision.
- It provides holes for the down lights or 1 long dado for a strip light.
- It also provides dados for the cables, in the panel, bottom and backs for CNC output.
- Attributes are used to control the sizes, positions, spacing etc for each of the Down lights.
- Up to 9 Downlights or 1 Strip light can be added per panel.
- The panel can be scribed to either side to run under multiple cabinets.
- Up to 6 different diameter lights can be configured.
- The width and depth of the strip light can also be controlled.
- The materials for the LED Down Lights are added with order codes for reporting purposes.
- The material for the transformer is also added for reporting.

Included in This Package

Materials:

Materials for six Down light sizes
Material for transformer for the Down light

User Created Standards

The Following UCSs are provided:

- { LIGHTS } -- LED DownLgt Cab Attributes Adds the Attributes to the cabinet
- { LIGHTS } -- LED DownLgt Panel + Dados Adds the dados to the panel and cabinet

Intellijoints

- U_Light_Panel_Bot_Hole Hole in cabinet bottom for cable (when bottom runs under the back)
- U_Light_Panel_Bck_Dado Dado in cabinet back for cable

Usage

Setting up the Cabinet.

- Start with a standard un-shaped Upper cabinet.
- Cabinet must have a bottom and unfinished back.
- Unfinished back must have vertical grain.

Adding the Panel Part

- Take the cabinet into the cabinet editor, click on New Part



- Choose Panel
- Make sure "Allow UCS Modification" is ticked.

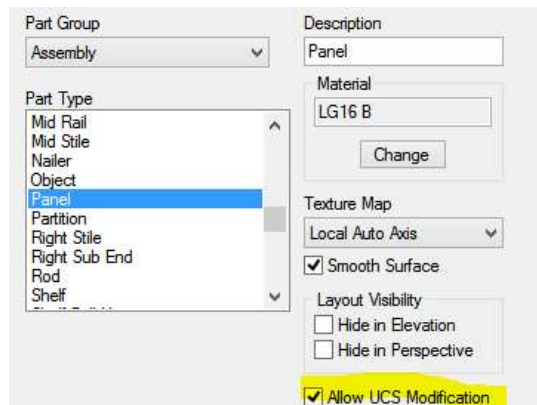

- Press Next, Next, Finish
- A Panel part will now appear next to the cabinet.
-

Panel Parameter

To activate the LED Down Light UCS's you **must** add a parameter to the panel:

- Right click on the Panel part you just added.
- Select Properties

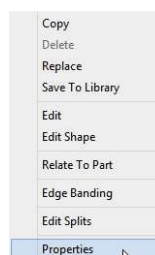

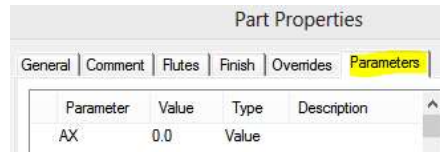

- Click the “Parameters” Tab
- Press “ADD”
- Type **LTP** in capitals for the name.

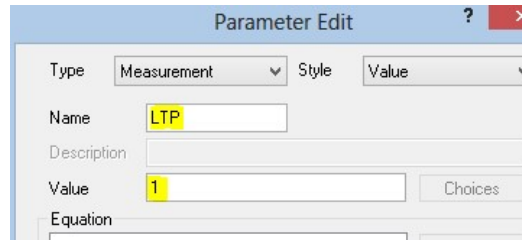

Enter 1 as the value:

- Press **OK**
- **The Panel will now be removed and the Cabinet Attributes will now be added:**

Cabinet Attributes

The **Lt Down Panel?** Attribute will now appear on the cabinet.

Note This Cabinet can now be saved to the library for re-use to avoid having to add the panel each time.

Now tick the **Lt Down Panel?** Attribute to true:

- The Light Panel will be added underneath the bottom with the Down light quantity set to 1.
- The following attributes will be added:

Lt Down .Panel?	True
Lt Down .QTY	1
Lt Down .Size	Size 1
Lt Down Pos Edit?	False
Lt Down Spacing?	Split Centers
Lt Down Z-Pos	150
Lt Down Trans Qty	None
Lt_Panel Banding	1 Front Only
Lt_Panel Scribe Bck	0
Lt_Panel Scribe Fnt	0
Lt_Panel Scribe Lft	0
Lt_Panel Scribe Rgt	0

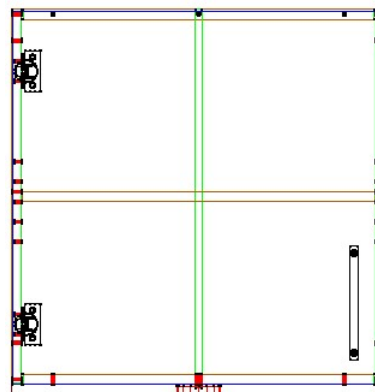

- **Note:** The panel is a system part – its material will be determined by the material schedule you have selected. Make sure the material assigned to the Panel part is the correct material for the panel. The Attribute controlled banding uses the system “Exterior Banding”. To apply a different banding select “manual” for the banding attribute as explained in the next section.

Attribute List:

Lt Down QTY (1 to 9) Sets the Down light quantity from 1 to a maximum of 9, (Strip) turns off the downlights and adds one strip light.

Lt Down Size Sets the Down light size.
For the Down lights there are 6 standard diameters to choose from.
(The default sizes are set in the UCS Public Variables explained in the next section)

Lt Down Pos Edit Allows the individual editing of the X position **of the center** of each Down light.
Lt Down Pos 1 X position of Down light 1.
Lt Down Pos 2 X position of Down light 2. Etc etc

Lt Down Spacing? Changes the way the “Left to Right” Down lights are spaced:-

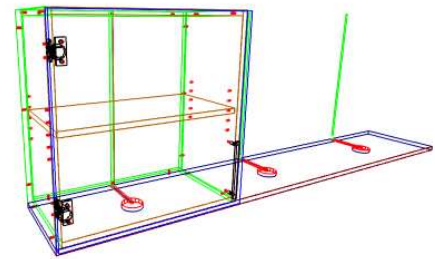
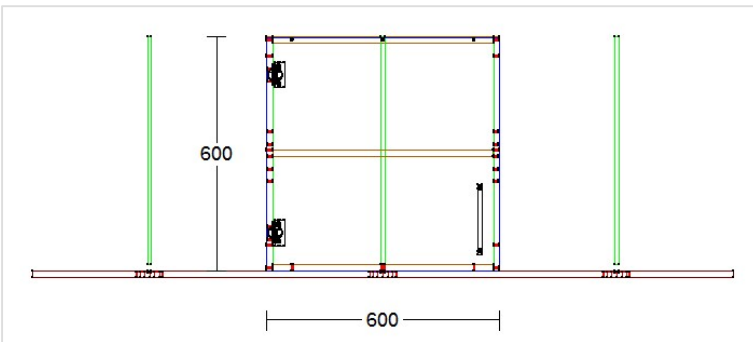

Split Centers Down Light is centered in each section of panel (default).

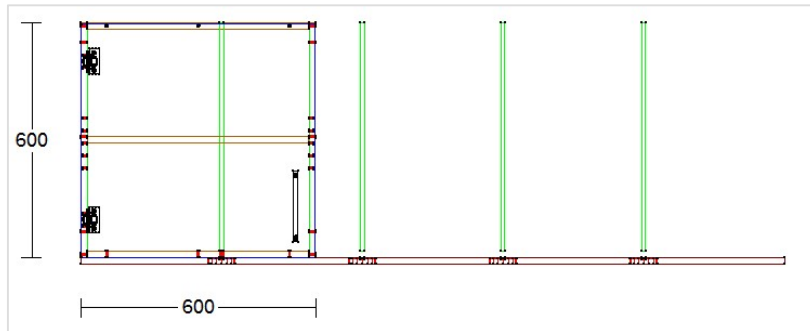

Equal Centers Center of each Down light is spaced equally

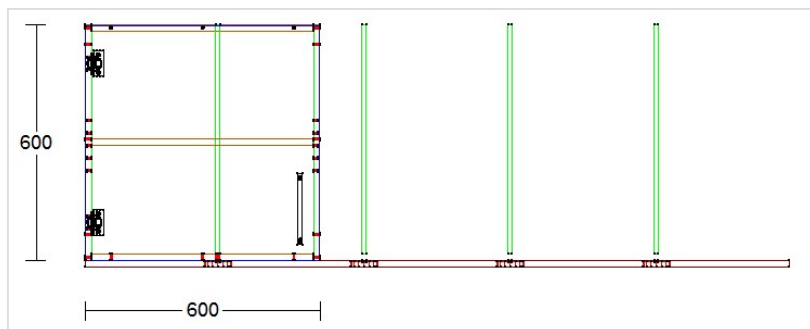

Equal Gaps Gaps between Down lights are equal.

Lt Down Z-Pos Changes the “In Out” position of all Down lights (default is center)

Lt Down Trans Qty Adds Transformers to the reports for ordering purposes.

Note the following six attributes only appear when “**Lt Down QTY**” is set to “**Strip**”

Lt Strip Cable L/R Strip light cable position Left , Right , Both or Off
Lt Strip Cable Pos L Strip light cable position value on Left
Lt Strip Cable Pos R Strip light cable position value on Right
Lt Strip Depth Strip light dado depth.
Lt Strip Inset Lft Strip light inset from left hand side of panel.
Lt Strip Inset Rgt Strip light inset from right hand side of panel.
Lt Strip Width Strip light dado width.
Lt Strip Z-Pos Strip light position from wall.

Lt Panel Banding Changes the edge banding of the panel:
Front only Edges the front edge only
Front + Left Edges the front and left edges
Front + Right Edges the front and right edges
Front + Both Edges the front and left and right edges
Manual De-activates the UCS applied banding and allows manual editing of the edge banding on the part itself.

Lt Panel Scribe Bck Changes the size of the panel at the back edge:
Lt Panel Scribe Fnt Changes the size of the panel at the front edge:
Lt Panel Scribe Lft Scribes the panel under the cabinets on the left:
Lt Panel Scribe Rgt Scribes the panel under the cabinets on the right:

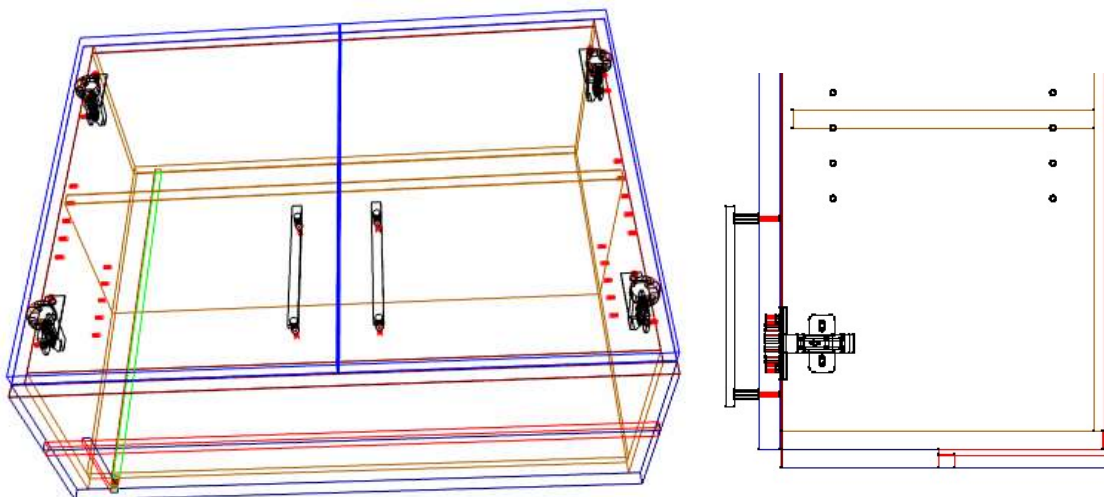

Strip Light selected

Machining Setup

UCS Public Variables

There are Public Variables in the “{ LIGHTS } -- LED DownLgt Cab Attributes” UCS.

- To change these variables go to the Utilities – Edit User Created Standards from the Room Plan or Elevation views

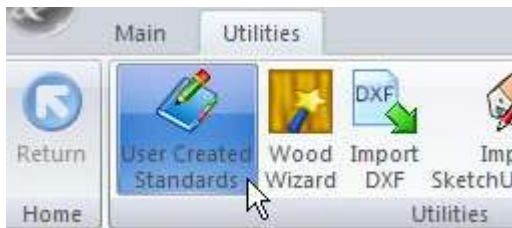

- Then click on the “{ LIGHTS } -- LED DownLgt Cab Attributes” UCS.
- On the top right hand side of the screen you will see the Public Variables list:

Public Variables	
Bottom Cable Hole Diam	Imp(10)
Cable Dado Depth	Imp(6)
Cable Dado Width	Imp(10)
Down Light Depth 1	Imp(13)
Down Light Depth 2	Imp(13)
Down Light Depth 3	Imp(13)
Down Light Depth 4	Imp(13)
Down Light Depth 5	Imp(13)
Down Light Depth 6	Imp(13)
Down Light Diam 1	Imp(20)
Down Light Diam 2	Imp(30)
Down Light Diam 3	Imp(40)
Down Light Diam 4	Imp(50)
Down Light Diam 5	Imp(60)
Down Light Diam 6	Imp(70)
Tool ID for Lights	0
Tool ID for Cable	0
Strip Light Width	Imp(15)
Strip Light Depth	Imp(12)

- Bot Cable hole Diam** = Diameter of Through Holes in the cabinet bottom for the cable (Only if bottom runs under back).
- Cable Dado Depth** = Depth of dado for cable in cabinet back and Light Panel.
- Cable Dado Width** = Width of dado for cable in cabinet back and Light Panel.
- Down Light Depth1-6** = Default Depth of hole for LED Down Light Size 1 to 6.
- Down Light Diam1-6** = Default diameter of hole for LED Down Light Size 1 to 6.
- Tool ID for Lights** = Tool ID from your tool catalog for the light dados in the light panel.
- Tool ID for Cable** = Tool ID from your tool catalog for the cable dados in the light panel.
- Strip Light Width** = Default width of dado for strip light.
- Strip Light Depth** = Default depth of dado for strip light.

NOTE: to select a TOOL for the cable dado in the cabinet backs you must use the Intellijoint catalog and click on the “U_Light_Panel_Bck_Dado” joint and change its tool in the drop down list.

- If your system is set to mm, Edit the values in the **Imp()** brackets to the diameter and depths you require.
- If your system is set to inches, simply replace the whole **imp()** with the imperial measurement instead.
- Eg: **Imp(3)** might become **1/8**

Once you have changed these values to your requirements, you can close the UCS editor.

Tools Required

- The drill diameters you choose in the UCS User Definable Variables above are all required for this package to work. You must have these tool diameters in your tool catalog and in your machine.

Material Properties

Name and Description

The materials added for the lights and transformers are as follows:

NAME	DESCRIPTION
LED DownLgt Size 1	LED Down Lights Size 1 #???????
LED DownLgt Size 2	LED Down Lights Size 2 #???????
LED DownLgt Size 3	LED Down Lights Size 3 #???????
LED DownLgt Size 4	LED Down Lights Size 4 #???????
LED DownLgt Size 5	LED Down Lights Size 5 #???????
LED DownLgt Size 6	LED Down Lights Size 6 #???????
LED DownLgt Trans	Transformer for Down Lights #???????
LED DownLgt Strip	LED Down Light Strip #???????
LED DownLgt Strip Tx	Transformer for Down Light Strip #???????

The materials added for the lights and transformers have a #???????? In the description which can be changed to the order codes you require. The code after the # symbol will appear on any material order reports you have purchased from Solid Setup Plus, or you can add a Vendor to the material and an SKU code instead.

The material names can also be changed if you prefer along with the vendor and pricing information.

Package Exclusions

Some of the items shown in various images contained in this document such as visual hinges etc, are not included in this Package, but come from other packages which are sold separately.

See our website for more detailed information on our other packages.

